

Brioso 6636

Model number:	103903
---------------	--------

Dimensions:	66" x 36" x 23"	Installation:	Freestanding	Material:	AcrylX™ Ap-
-------------	-----------------	---------------	--------------	-----------	-------------





Standard Features:
<ul style="list-style-type: none">• 2-piece bathtub with transitional look and concealed seam• Ample deck space for faucet installation• Maximized bathing well with center drain• Above-the-Floor Rough (AFR)• F² Drain compatible for fast & easy installation• Apron available in white and 3 designer colors
Product characteristics:
<ul style="list-style-type: none">• 1 Tub - 2 Pieces• Easy Installation• Deck Space for Faucet
Warranty:
Lifetime limited

Standard colors:

	White (002)
--	-------------

Certifications

MAAX products adhere to one or more of the following certifications:



Options (Visit our website for a complete list of our options)

No	Description
<input type="checkbox"/> OPT 20252	Linear Waste and overflow
<input type="checkbox"/> OPT 20137	Cable-operated waste and overflow
<input type="checkbox"/> OPT 20210	Waste and overflow
<input type="checkbox"/> OPT 20250	Brass waste and overflow for high-rise construction

Brioso 6636

Model number:

103903

Dimensions:

66" x 36" x 23"

Installation:

Freestanding

Material:

AcrylIX™ Ap-

1

Dimensions:
66 x 36 x 23 in. (1676 x 914 x 584 mm)
Water capacity:
68 gallons - 259 liters
Weight:
106 lbs - 48.07 kg
Bathing well:
62 7/8 X 28 in. (1597 X 711 mm)
Deep sump height:
18 5/8 in. - 473 mm
Deck width:
4 1/2 in. - 114 mm
Drain location:
Center

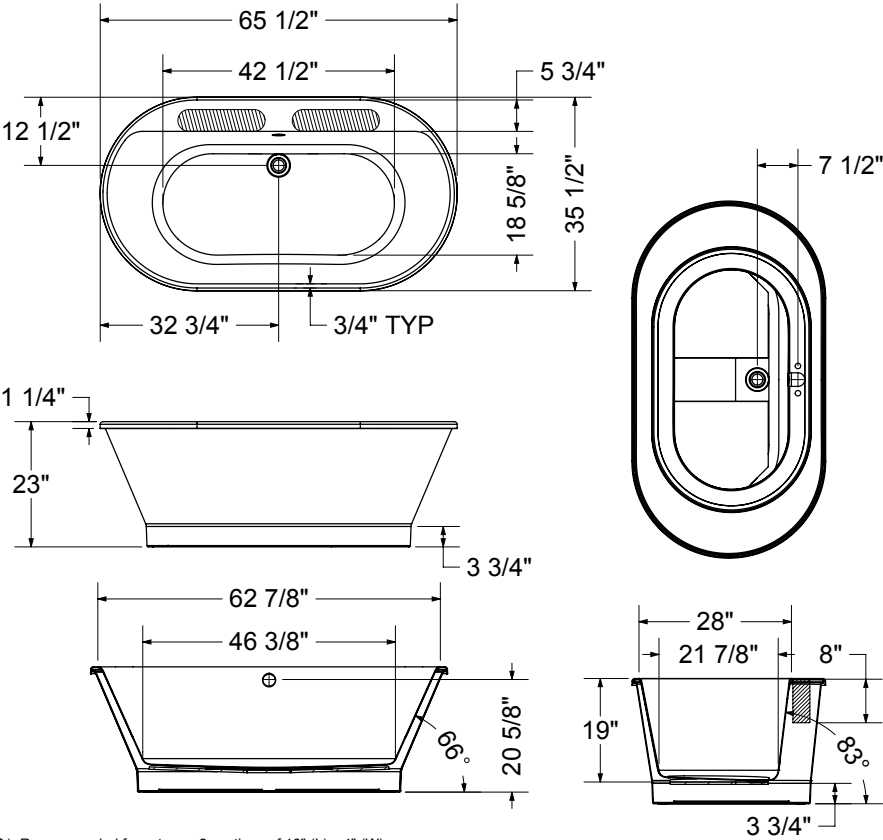

(): Recommended faucet area 2 sections of 16" (L) x 4" (W).
Depth recommended for straight pipes 8".

All dimensions are approximate. Structure measurements must be verified against the unit to ensure proper fit.

Project:

Contractor:

Representative:

Date:

Tel:

Notes: