

# Ariosa 6636

Model number:	106267
---------------	--------

Dimensions: 66" x 36" x 28"

Installation: Freestanding

Material: Acrylic



**Standard Features:**

- 2-piece bathtub with symmetrical look and concealed seam
- Recessed deck with ample space for faucet installation
- Maximized bathing well with center drain
- Above-the-Floor Rough (AFR) and F<sup>2</sup> Drain compatible
- MAAX innovative leveling legs
- Apron available in white and 5 designer

**Product characteristics:**

- Bestseller
- Deck Space for Faucet
- F2 Drain compatible

**Warranty:**

25 Years



**Standard colors:**



White (001)

**Certifications**

MAAX products adhere to one or more of the following certifications:



**Options** (Visit our website for a complete list of our options)

No	Description
<input type="checkbox"/> OPT 20252	Linear Waste and overflow
<input type="checkbox"/> OPT 20137	Cable-operated waste and overflow
<input type="checkbox"/> OPT 20250	Brass waste and overflow for high-rise construction

# Ariosa 6636

Model number:	106267
---------------	--------

Dimensions:	66" x 36" x 28"	Installation:	Freestanding	Material:	Acrylic
-------------	-----------------	---------------	--------------	-----------	---------

**Dimensions:**

66 x 36 x 28 in.  
(1676 x 914 x 711 mm)

**Water capacity:**

56 gallons - 214 liters

**Weight:**

98 lbs - 44.44 kg

**Bathing well:**

63 1/2 X 28 1/2 in.  
(1613 X 724 mm)

**Deep sump height:**

18 7/8 in. - 479 mm

**Deck width:**

4 3/8 in. - 111 mm

**Drain location:**

Center

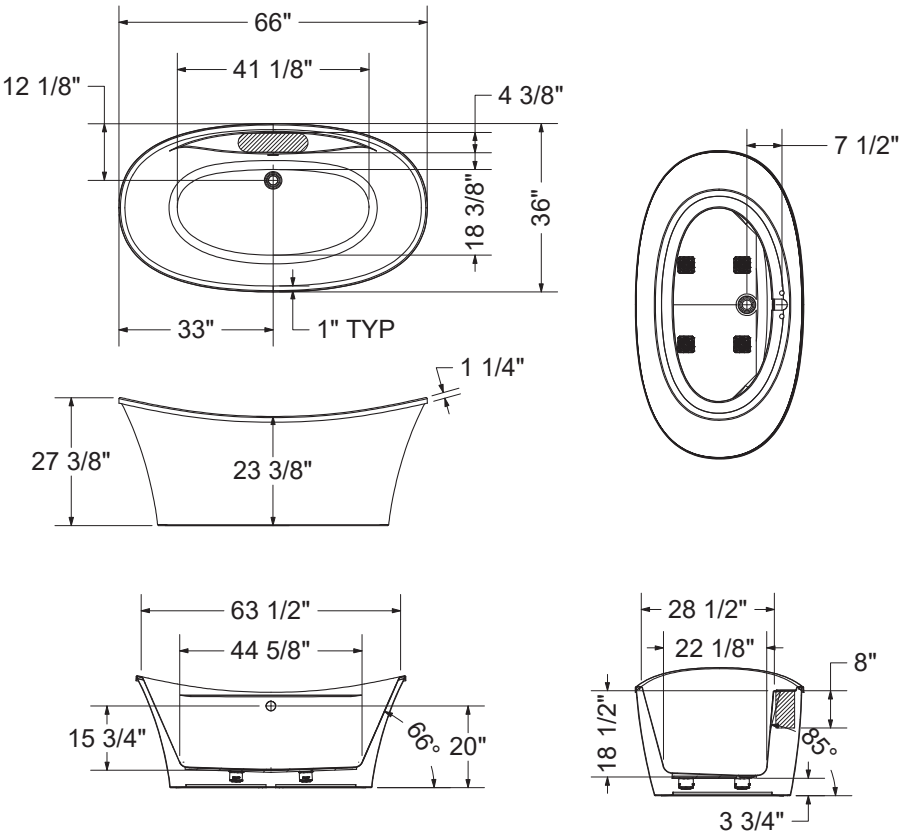

( ) : Recommended faucet area of 15" (L) x 4" (W).  
Depth recommended for straight pipes 8".  
All dimensions are approximate. Structure measurements must be verified against the unit to ensure proper fit.

Project:	
Contractor:	
Representative:	
Date:	
Tel:	
Notes:	