



Ref:	Description:	SKU:
1	Hydraulic Motor	MO15JP
2	Balanced Valve Assembly	BV15JP
3	End Bearing	CPG15JP
4	Front Bearing	CPM15JP
5	Tensioner	TEN15JP
6	Gearbox	GBT15JP
7	Clutch Assembly	CLU15JP
8	Cable with Hook	ST15JP
9	Hook	HK15JP

WW WARRIOR WINCHES INDUSTRIAL

MODEL / 15JP0IH-CAD

MOTOR TYPE / Hydraulic 15.2 ci (250cc)

CERTIFICATION / SAEJ-706

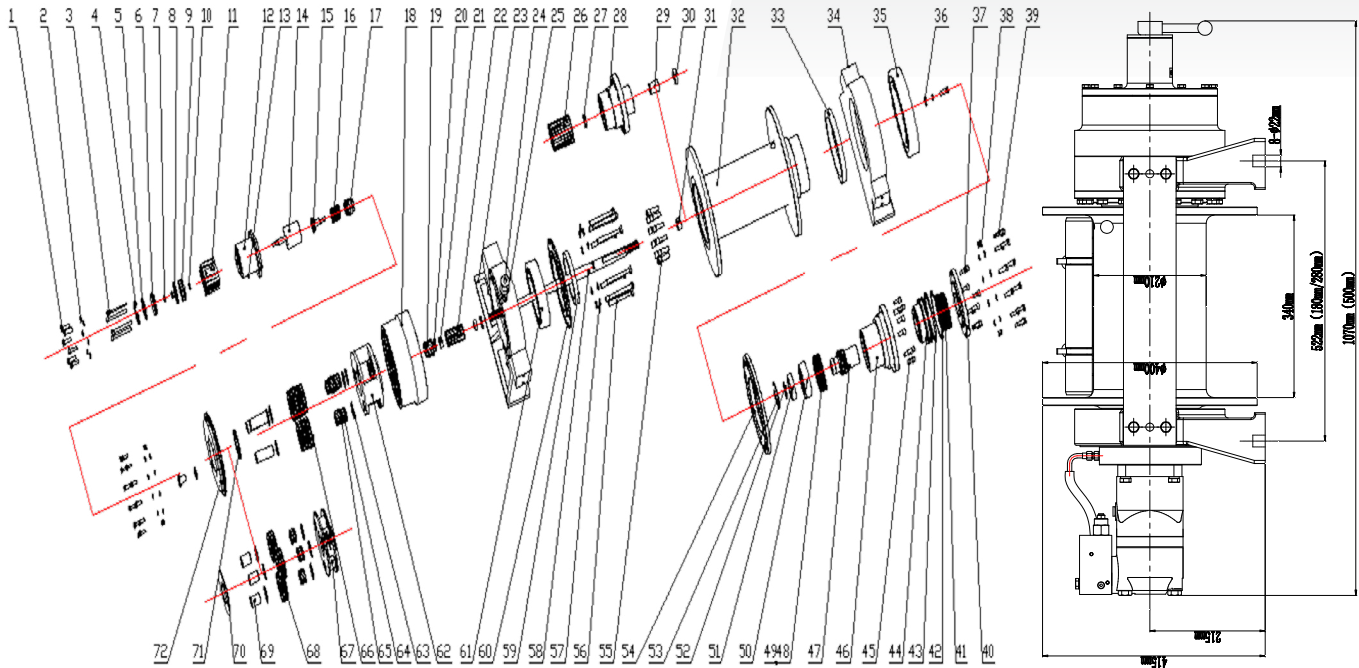

#	Part Number	Description	Qty.
1	GB5783-86	Bolt M8*20	6
2	GB93-87	Gasket 8	6
3	GB70.1-2000	Screw M12*55	4
4	GB893.1-86	check ring 65	1
5	GB3452.1-2005	O-ring 58*2.65	2
6	IYJ100.1-1	Cylinder cover	1
7	GB/T6172.1-2000	Nut M10	2
8	GB3452.1-2005	O-ring 58*2.65	2
9	IYJ100.1-2	Bib	1
10	GB3452.1-2005	O-ring 58*2.65	1
11	IYJ100.1-9B	Cylinder liner	1
12	IYJ100.1-8	Air vat	1
13	IYJ150.4-2	Screw	1
14	IYJ150.4-1	Fork	1
15	IYJ100.1-5	Spring seat	1
16	IYJ100.1-4	Spring	1
17	IYJ150.4-3	linker	1
18	IYJ150-2	Gear ring	1
19	IYJ150-14	First stage sun gear	1
20	IYJ150-12	Cover	2
21	IYJ150.1-8	Cover	2
22	IYJ150.1-7	Second stage sun gear	1
23	IYJ150-10	The left bearing	1
24	JB1001-77	Ventilate plug screw	2

#	Part Number	Description	Qty.
25	JB982-77	Gasket 20	2
26	IYJ150-11	Driver axle	1
27	IYJ150-12	Gasket	1
28	IYJ150-11	The middle axle	1
29	IYJ150-7	Gasket	1
30	GB3452.1-85	Oil seal 32x52x8	1
31	IYJ150-12	Gasket	1
32	IYJ150-4	Drum	1
33	GB9877.1-86	Oil seal 200*230*15	1
34	IYJ150-5	The right bearing	1
35	GB276-89	Bring 61938	1
36	IYJ150-7	Gasket	1
37	GB70-85	Screw M10*20	8
38	GB93-87	Gasket 10	13
39	GB5783-86	Bolt M10*30	13
40	IYJ150.3-4	Motor seat	1
41	Z30A-16	Spring	16
42	GB3452.1-86	check ring A124*136*2	1
43	GB3452.1-86	O-ring 120*7	1
44	IHKNB21E.1-2	Bib	1
45	GB70-85	Screw M10*30	12
46	IYJ150.3-2	Brake cage	1
47	IYJ150.3-3	Splined hub	1
48	HS70K-11	Inner friction disc	6
49	HS70K-10A	outside friction disc	7
50	IYJ150.3-5	Bring seat	1

#	Part Number	Description	Qty.
51	GB276-89	Bring 61916	1
52	GB893.1-86	check ring 75	1
53	JB/ZQ4341-1997	check ring 102*4	1
54	IYJ150.3-1	Cover	1
55	GB70-85	Screw M12*45	20
56	GB5782-86	Bolt M12*100	12
57	GB93-87	Gasket 12	12
58	IYJ150-6	Driver axle	1
59	GB9877.1-86	Oil seal 130*160*12	1
60	IYJ150-3	Driver axle	1
61	GB288-87	Bring 3053124	1
62	IYJ150.1-2	Second stage planet carrier	1
63	IYJ150.1-4	First stage planet gasket	12
64	GB309-84	Roller 5*21.8	252
65	IYJ150-9	Gasket	3
66	IYJ150.2-3	Second stage planet gear	3
67	IYJ150.1-6	First stage planet carrier	1
68	IYJ150.1-3	First stage planet gear	3
69	IYJ150.1-2	First stage planet axle	3
70	IYJ150.1-1	Gasket	1
71	IYJ150-13	Gasket	1
72	IYJ150-1	Cover	1