

INSTRUCTIONS FOR USE

ManaEZ[®] Rom Elite Short

MD

Product Description: The ManaEZ ROM Elite Short is a knee orthosis, designed to provide medial and lateral support to the knee joint as well as control range of motion per physicians orders.

Indications for use: Provides range of motion control, Medial/lateral stability to sprains and strains of the knee. Ideal for post op recovery of knee repairs where limited range of motion is required.

Contraindications: If you experience increased pain, swelling, skin irritation or any adverse reaction while using this product contact your medical professional immediately.

Warning: This device will not prevent or reduce injuries. Proper rehabilitation and activity modification are an essential part of the treatment program. Do not change range of motion settings without direction of a medical professional.

Required Components: The ManaEZ ROM Elite Short consists of two aluminum uprights with range of motion hinges, removable pads with circumferential straps.

Washing and Care: Prior to cleaning, remove pads. Hand wash pads with a mild detergent and let it air dry. Use damp cloth to wipe down aluminum uprights. Do not machine wash or dry.

Instructions:

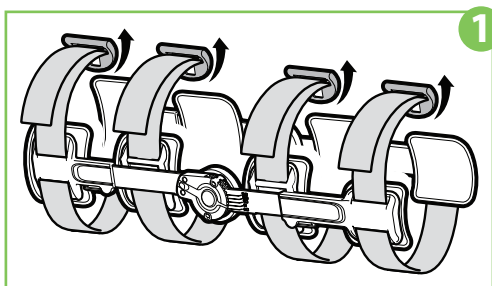

1. Take off 4 hooks

- Detach all four straps and open the brace
- Place the brace under the leg.

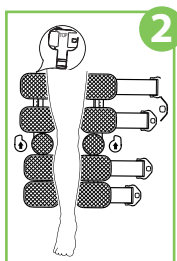

Expand the product

Place the patient's leg in the middle of the expanded product. The center of hinge should align with the knee joint.

Note: The plastic bar marked with a label "TOP" will be on the thigh side, and the other side of the brace will be on the calf side.

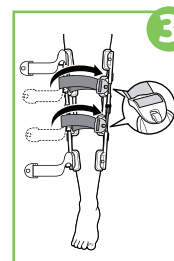

3. Fasten Straps

Place the strap tab hole over the plastic hook on the opposite upright. pull to lock in place. Pull the hook and loop strap closure apart and pull strap to the desired tension, then secure hook and loop closure.

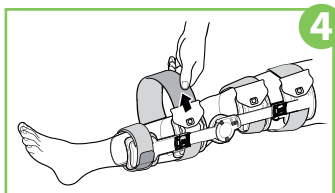

5. Trim Excess

If necessary trim excess strap by removing the hook and loop tab from the strap. Trim excess strap length and reapply hook and loop tab.

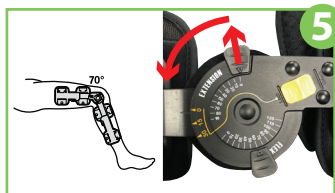

6. Extension

To control Extension, pull the extension tab out and move to desired setting between 0° and 90° and release tab to lock into position.

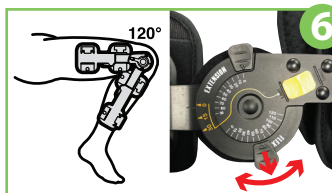

7. Flexion

To control Flexion, pull the Flexion tab out and move to desired setting between 0° and 120° and release tab to lock into position.



8. Quick Lock

The hinge can be locked out at 0°, 15°, 30° by sliding the yellow tab into the locked position.

Disposal: The device and packaging must be disposed of in accordance with respective local or national environmental regulations.

Liability: ManaMed does not assume liability for the following:

- Device not maintained as instructed by the Instructions For Use.
- Device assembled with components from other manufacturers.
- Device used outside of recommended use condition, application, or environment.

Symbol Glossary: For an explanation of symbols, please refer to <https://www.manamed.com/glossary/symbol-glossary.pdf>



MANAMED

ManaMed, LLC
2612 Sirius Dr.
Denton, TX 76208
Ph: 888-508-0712
www.Manamed.com

©2024 ManaMed LLC. All rights reserved.
ManaMed, the ManaMed logo,
are trademarks of ManaMed LLC
Registered in the U.S.