



certifix
YOUR FIXING SPECIALIST

CERTIFIX RS-AL-ST

Dome Headed, Standard Aluminium/Steel Rivets



PRODUCT DESCRIPTION

Certifix Standard rivets are versatile blind rivets featuring a breaking mandrel. They offer a swift and effortless solution for joining various materials where exceptionally high torque isn't required.

Available in a wide diameter range of 2.4mm to 7.8mm, Certifix Standard rivets accommodate a broad spectrum of grip ranges, from 0.8mm to 185mm. The extensive material selection and diverse finishing options, including lacquering and protective coatings, provide unparalleled customization possibilities

PRODUCT FEATURES

- Single-side access (blind rivet).
- It covers a wide grip range; from 0.8 mm. to 185 mm.
- Can be fixed from both ends.
- Wide range of diameters: from 2.4 mm. to 7.8 mm.
- Can fasten different materials with different types of manufacturing: composites, laminate materials, heat treated, etc.
- Does not deform surfaces after the riveting process is finished (painted, glazed surfaces, etc.)
- Good resistance to temperature variations.
- Does not come loose from dynamic stress (vibrations in general)
- Available in alloy magnesium contents of 3.5 and 5.0, which give a great tensile and shear strength, an excellent clamping force and a high resistance to corrosion.
- Fast, simple and great quality assembly.
- The riveting process is environmentally friendly, free of smoke, sparks, fumes.
- It requires simple, fast and lightweight tools.





TECHNICAL DATA

SKU	Body Diameter	Body Length	Drill Hole Diameter	Head Diameter	Head Thickness	Mandrel Diameter	Pack Size	Grip Range	Shear Strength	Tensile Strength
RS-AL-ST-2.4×4	2.4 mm	4 mm	2.5 mm	5.0 mm	0.6 mm	1.45 mm	1000	0.5 - 2.0 mm	350 N	550 N
RS-AL-ST-2.4×6	2.4 mm	6 mm	2.5 mm	5.0 mm	0.6 mm	1.45 mm	1000	2.0 - 4.0 mm	350 N	550 N
RS-AL-ST-2.4×8	2.4 mm	8 mm	2.5 mm	5.0 mm	0.6 mm	1.45 mm	1000	4.0 - 6.0 mm	350 N	550 N
RS-AL-ST-2.4×10	2.4 mm	10 mm	2.5 mm	5.0 mm	0.6 mm	1.45 mm	1000	6.0 - 8.0 mm	350 N	550 N
RS-AL-ST-2.4×12	2.4 mm	12 mm	2.5 mm	5.0 mm	0.6 mm	1.45 mm	1000	8.0 - 9.5 mm	350 N	550 N
RS-AL-ST-3.0×4	3.0 mm	4mm	3.1 mm	6.0 mm	1.0 mm	1.80 mm	500	0.5 - 1.5 mm	550 N	850 N
RS-AL-ST-3.0×5	3.0 mm	5mm	3.1 mm	6.0 mm	1.0 mm	1.80 mm	500	0.5 - 2.5 mm	550 N	850 N
RS-AL-ST-3.0×6	3.0 mm	6 mm	3.1 mm	6.0 mm	1.0 mm	1.80 mm	500	1.5 - 3.5 mm	550 N	850 N
RS-AL-ST-3.0×7	3.0 mm	7 mm	3.1 mm	6.0 mm	1.0 mm	1.80 mm	500	1.5 - 4.5 mm	550 N	850 N
RS-AL-ST-3.0×8	3.0 mm	8 mm	3.1 mm	6.0 mm	1.0 mm	1.80 mm	500	3.5 - 5.0 mm	550 N	850 N
RS-AL-ST-3.0×9	3.0 mm	9 mm	3.1 mm	6.0 mm	1.0 mm	1.80 mm	500	5.5 - 6.0 mm	550 N	850 N
RS-AL-ST-3.0×10	3.0 mm	10 mm	3.1 mm	6.0 mm	1.0 mm	1.80 mm	500	5.0 - 7.0 mm	550 N	850 N
RS-AL-ST-3.0×12	3.0 mm	12 mm	3.1 mm	6.0 mm	1.0 mm	1.80 mm	500	7.0 - 9.0 mm	550 N	850 N
RS-AL-ST-3.0×14	3.0 mm	14 mm	3.1 mm	6.0 mm	1.0 mm	1.80 mm	500	9.0 - 11.0 mm	550 N	850 N
RS-AL-ST-3.0×16	3.0 mm	16 mm	3.1 mm	6.0 mm	1.0 mm	1.80 mm	500	11.0 - 13.0 mm	550 N	850 N
RS-AL-ST-3.0×18	3.0 mm	18 mm	3.1 mm	6.0 mm	1.0 mm	1.80 mm	500	13.0 - 15.0 mm	550 N	850 N
RS-AL-ST-3.2×4	3.2 mm	4 mm	3.3 mm	6.4 mm	1.0 mm	1.80 mm	500	0.5 - 2.5 mm	750 N	1100 N
RS-AL-ST-3.2×5	3.2 mm	5 mm	3.3 mm	6.4 mm	1.0 mm	1.80 mm	500	0.5 - 2.5 mm	750 N	1100 N
RS-AL-ST-3.2×6	3.2 mm	6 mm	3.3 mm	6.4 mm	1.0 mm	1.80 mm	500	1.5 - 3.5 mm	750 N	1100 N
RS-AL-ST-3.2×8	3.2 mm	8 mm	3.3 mm	6.4 mm	1.0 mm	1.80 mm	500	3.5 - 5.0 mm	750 N	1100 N
RS-AL-ST-3.2×10	3.2 mm	10 mm	3.3 mm	6.4 mm	1.0 mm	1.80 mm	500	5.0 - 7.0 mm	750 N	1100 N
RS-AL-ST-3.2×12	3.2 mm	12 mm	3.3 mm	6.4 mm	1.0 mm	1.80 mm	500	7.0 - 9.0 mm	750 N	1100 N
RS-AL-ST-3.2×15	3.2 mm	15 mm	3.3 mm	6.4 mm	1.0 mm	1.80 mm	500	9.0 - 12.0 mm	750 N	1100 N
RS-AL-ST-3.2×18	3.2 mm	18 mm	3.3 mm	6.4 mm	1.0 mm	1.80 mm	500	12.0 - 15.0 mm	750 N	1100 N
RS-AL-ST-3.2×20	3.2 mm	20 mm	3.3 mm	6.4 mm	1.0 mm	1.80 mm	500	15.0 - 18.0 mm	750 N	1100 N

APPLICATIONS

- Automotive industry
- Bodyworks – commercial vehicles
- Electronics
- Air Conditioning and Heating
- Construction
- Metal industry
- Metal furniture
- Electrical appliances
- Ladder manufacturing

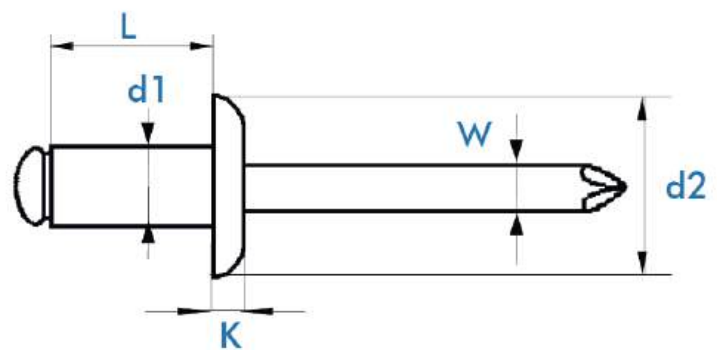



TECHNICAL DATA

SKU	Body Diameter	Body Length	Drill Hole Diameter	Head Diameter	Head Thickness	Mandrel Diameter	Pack Size	Grip Range	Shear Strength	Tensile Strength
RS-AL-ST-4.0×5	4.0 mm	5 mm	4.1 mm	8.0 mm	1.4 mm	2.20 mm	500	0.5 - 2.5 mm	1250 N	1800 N
RS-AL-ST-4.0×6	4.0 mm	6 mm	4.1 mm	8.0 mm	1.4 mm	2.20 mm	500	1.0 - 3.0 mm	1250 N	1800 N
RS-AL-ST-4.0×7	4.0 mm	7 mm	4.1 mm	8.0 mm	1.4 mm	2.20 mm	500	3.0 - 4.5 mm	1250 N	1800 N
RS-AL-ST-4.0×8	4.0 mm	8 mm	4.1 mm	8.0 mm	1.4 mm	2.20 mm	500	3.0 - 5.0 mm	1250 N	1800 N
RS-AL-ST-4.0×10	4.0 mm	10 mm	4.1 mm	8.0 mm	1.4 mm	2.20 mm	500	5.0 - 6.5 mm	1250 N	1800 N
RS-AL-ST-4.0×12	4.0 mm	12 mm	4.1 mm	8.0 mm	1.4 mm	2.20 mm	500	6.5 - 8.5 mm	1250 N	1800 N
RS-AL-ST-4.0×14	4.0 mm	14 mm	4.1 mm	8.0 mm	1.4 mm	2.20 mm	500	8.5 - 10.5 mm	1250 N	1800 N
RS-AL-ST-4.0×16	4.0 mm	16 mm	4.1 mm	8.0 mm	1.4 mm	2.20 mm	500	10.5 - 12.5 mm	1250 N	1800 N
RS-AL-ST-4.0×18	4.0 mm	18 mm	4.1 mm	8.0 mm	1.4 mm	2.20 mm	500	12.5 - 14.5 mm	1250 N	1800 N
RS-AL-ST-4.0×20	4.0 mm	20 mm	4.1 mm	8.0 mm	1.4 mm	2.20 mm	500	14.5 - 16.5 mm	1250 N	1800 N
RS-AL-ST-4.0×25	4.0 mm	25 mm	4.1 mm	8.0 mm	1.4 mm	2.20 mm	250	16.5 - 21.5 mm	1250 N	1800 N
RS-AL-ST-4.0×30	4.0 mm	30 mm	4.1 mm	8.0 mm	1.4 mm	2.20 mm	250	21.5 - 26.0 mm	1250 N	1800 N
RS-AL-ST-4.0×35	4.0 mm	35 mm	4.1 mm	8.0 mm	1.4 mm	2.20 mm	250	26.0 - 31.0 mm	1250 N	1800 N
RS-AL-ST-4.0×40	4.0 mm	40 mm	4.1 mm	8.0 mm	1.4 mm	2.20 mm	250	31.0 - 36.0 mm	1250 N	1800 N
RS-AL-ST-4.8×6	4.8 mm	6 mm	4.9 mm	9.5 mm	1.5 mm	2.65 mm	500	0.5 - 3.0 mm	1850 N	2600 N
RS-AL-ST-4.8×8	4.8 mm	8 mm	4.9 mm	9.5 mm	1.5 mm	2.65 mm	500	3.0 - 4.5 mm	1850 N	2600 N
RS-AL-ST-4.8×10	4.8 mm	10 mm	4.9 mm	9.5 mm	1.5 mm	2.65 mm	500	4.5 - 6.0 mm	1850 N	2600 N
RS-AL-ST-4.8×12	4.8 mm	12 mm	4.9 mm	9.5 mm	1.5 mm	2.65 mm	500	6.0 - 8.0 mm	1850 N	2600 N
RS-AL-ST-4.8×14	4.8 mm	14 mm	4.9 mm	9.5 mm	1.5 mm	2.65 mm	250	8.0 - 10.0 mm	1850 N	2600 N
RS-AL-ST-4.8×16	4.8 mm	16 mm	4.9 mm	9.5 mm	1.5 mm	2.65 mm	250	10.0 - 12.0 mm	1850 N	2600 N
RS-AL-ST-4.8×18	4.8 mm	18 mm	4.9 mm	9.5 mm	1.5 mm	2.65 mm	250	12.0 - 14.0 mm	1850 N	2600 N
RS-AL-ST-4.8×21	4.8 mm	21 mm	4.9 mm	9.5 mm	1.5 mm	2.65 mm	250	14.0 - 17.0 mm	1850 N	2600 N
RS-AL-ST-4.8×24	4.8 mm	24 mm	4.9 mm	9.5 mm	1.5 mm	2.65 mm	200	17.0 - 20.0 mm	1850 N	2600 N
RS-AL-ST-4.8×27	4.8 mm	27 mm	4.9 mm	9.5 mm	1.5 mm	2.65 mm	200	20.0 - 23.0 mm	1850 N	2600 N
RS-AL-ST-4.8×30	4.8 mm	30 mm	4.9 mm	9.5 mm	1.5 mm	2.65 mm	200	23.0 - 25.0 mm	1850 N	2600 N
RS-AL-ST-4.8×32	4.8 mm	32mm	4.9 mm	9.5 mm	1.5 mm	2.65 mm	200	25.0 - 27.0 mm	1850 N	2600 N
RS-AL-ST-4.8×35	4.8 mm	35 mm	4.9 mm	9.5 mm	1.5 mm	2.65 mm	200	27.0 - 30.0 mm	1850 N	2600 N
RS-AL-ST-4.8×40	4.8 mm	40 mm	4.9 mm	9.5 mm	1.5 mm	2.65 mm	150	30.0 - 35.0 mm	1850 N	2600 N
RS-AL-ST-4.8×45	4.8 mm	45 mm	4.9 mm	9.5 mm	1.5 mm	2.65 mm	100	35.0 - 40.0 mm	1850 N	2600 N
RS-AL-ST-4.8×50	4.8 mm	50 mm	4.9 mm	9.5 mm	1.6 mm	2.65 mm	100	40.0 - 45.0 mm	1850 N	2600 N
RS-AL-ST-5.0×6	5.0 mm	6mm	5.1 mm	9.5 mm	1.6 mm	2.65 mm	500	0.5 - 3.0 mm	2150 N	3100 N
RS-AL-ST-5.0×8	5.0 mm	8 mm	5.1 mm	9.5 mm	1.6 mm	2.65 mm	500	3.0 - 4.5 mm	2150 N	3100 N
RS-AL-ST-5.0×10	5.0 mm	10 mm	5.1 mm	9.5 mm	1.6 mm	2.65 mm	500	4.5 - 6.0 mm	2150 N	3100 N
RS-AL-ST-5.0×12	5.0 mm	12 mm	5.1 mm	9.5 mm	1.6 mm	2.65 mm	500	6.0 - 8.0 mm	2150 N	3100 N
RS-AL-ST-5.0×14	5.0 mm	14 mm	5.1 mm	9.5 mm	1.6 mm	2.65 mm	250	8.0 - 10.0 mm	2150 N	3100 N
RS-AL-ST-5.0×16	5.0 mm	16 mm	5.1 mm	9.5 mm	1.6 mm	2.65 mm	250	10.0 - 12.0 mm	2150 N	3100 N
RS-AL-ST-5.0×18	5.0 mm	18 mm	5.1 mm	9.5 mm	1.6 mm	2.65 mm	250	12.0 - 14.0 mm	2150 N	3100 N
RS-AL-ST-5.0×20	5.0 mm	20 mm	5.1 mm	9.5 mm	1.6 mm	2.65 mm	250	14.0 - 16.0 mm	2150 N	3100 N
RS-AL-ST-5.0×25	5.0 mm	25 mm	5.1 mm	9.5 mm	1.6 mm	2.65 mm	200	16.0 - 21.0 mm	2150 N	3100 N
RS-AL-ST-5.0×30	5.0 mm	30 mm	5.1 mm	9.5 mm	1.6 mm	2.65 mm	200	21.0 - 25.0 mm	2150 N	3100 N
RS-AL-ST-5.0×35	5.0 mm	35 mm	5.1 mm	9.5 mm	1.6 mm	2.65 mm	150	27.0 - 30.0 mm	2150 N	3100 N
RS-AL-ST-5.0×40	5.0 mm	40 mm	5.1 mm	9.5 mm	1.6 mm	2.65 mm	150	30.0 - 35.0 mm	2150 N	3100 N
RS-AL-ST-5.0×45	5.0 mm	45 mm	5.1 mm	9.5 mm	1.6 mm	2.65 mm	100	35.0 - 40.0 mm	2150 N	3100 N
RS-AL-ST-5.0×50	5.0 mm	50 mm	5.1 mm	9.5 mm	1.6 mm	2.65 mm	100	40.0 - 45.0 mm	2150 N	3100 N





TECHNICAL DATA

SKU	Body Diameter	Body Length	Drill Hole Diameter	Head Diameter	Head Thickness	Mandrel Diameter	Pack Size	Grip Range	Shear Strength	Tensile Strength
RS-AL-ST-6.0x8	6.0 mm	8 mm	6.1 mm	12.0 mm	1.8 mm	3.2 mm	250	2.0 - 3.0 mm	3200 N	4600 N
RS-AL-ST-6.0x10	6.0 mm	10 mm	6.1 mm	12.0 mm	1.8 mm	3.2 mm	250	3.0 - 5.0 mm	3200 N	4600 N
RS-AL-ST-6.0x12	6.0 mm	12 mm	6.1 mm	12.0 mm	1.8 mm	3.2 mm	250	5.0 - 7.0 mm	3200 N	4600 N
RS-AL-ST-6.0x14	6.0 mm	14 mm	6.1 mm	12.0 mm	1.8 mm	3.2 mm	250	7.0 - 9.0 mm	3200 N	4600 N
RS-AL-ST-6.0x16	6.0 mm	16 mm	6.1 mm	12.0 mm	1.8 mm	3.2 mm	250	9.0 - 11.0 mm	3200 N	4600 N
RS-AL-ST-6.0x18	6.0 mm	18 mm	6.1 mm	12.0 mm	1.8 mm	3.2 mm	200	11.0 - 13.0 mm	3200 N	4600 N
RS-AL-ST-6.0x20	6.0 mm	20 mm	6.1 mm	12.0 mm	1.8 mm	3.2 mm	200	13.0 - 15.0 mm	3200 N	4600 N
RS-AL-ST-6.0x25	6.0 mm	25 mm	6.1 mm	12.0 mm	1.8 mm	3.2 mm	200	15.0 - 20.0 mm	3200 N	4600 N
RS-AL-ST-6.0x30	6.0 mm	30 mm	6.1 mm	12.0 mm	1.8 mm	3.2 mm	150	20.0 - 25.0 mm	3200 N	4600 N
RS-AL-ST-6.0x35	6.0 mm	35 mm	6.1 mm	12.0 mm	1.8 mm	3.2 mm	100	25.0 - 30.0 mm	3200 N	4600 N
RS-AL-ST-6.4x12	6.4 mm	12 mm	6.5 mm	13.0 mm	2.2 mm	3.6 mm	250	3.0 - 6.0 mm	3400 N	4850 N
RS-AL-ST-6.4x15	6.4 mm	15 mm	6.5 mm	13.0 mm	2.2 mm	3.6 mm	250	6.0 - 9.0 mm	3400 N	4850 N
RS-AL-ST-6.4x18	6.4 mm	18 mm	6.5 mm	13.0 mm	2.2 mm	3.6 mm	200	9.0 - 12.0 mm	3400 N	4850 N
RS-AL-ST-6.4x22	6.4 mm	22 mm	6.5 mm	13.0 mm	2.2 mm	3.6 mm	200	12.0 - 16.0 mm	3400 N	4850 N
RS-AL-ST-6.4x26	6.4 mm	26 mm	6.5 mm	13.0 mm	2.2 mm	3.6 mm	150	16.0 - 20.0 mm	3400 N	4850 N
RS-AL-ST-6.4x30	6.4 mm	30 mm	6.5 mm	13.0 mm	2.2 mm	3.6 mm	150	20.0 - 22.0 mm	3400 N	4850 N
RS-AL-ST-6.4x35	6.4 mm	35 mm	6.5 mm	13.0 mm	2.2 mm	3.6 mm	100	24.0 - 29.0 mm	3400 N	4850 N
RS-AL-ST-6.4x40	6.4 mm	40 mm	6.5 mm	13.0 mm	2.2 mm	3.6 mm	100	29.0 - 34.0 mm	3400 N	4850 N
RS-AL-ST-6.4x50	6.4 mm	50 mm	6.5 mm	13.0 mm	2.2 mm	3.6 mm	100	29.0 - 42.0 mm	3400 N	4850 N
RS-AL-ST-7.8x15	7.8 mm	15 mm	8.0 mm	13.5 mm	2.2 mm	3.6 mm	100	6.0 - 9.0 mm	5000 N	7500 N
RS-AL-ST-7.8x22	7.8 mm	22 mm	8.0 mm	13.5 mm	2.2 mm	3.6 mm	100	9.0 - 16.0 mm	5000 N	7500 N

ADDITIONAL TOOLS

Certifix can supply:

- BET-2 Rivet Gun
- Makita 18V Rivet Gun
- HSS bits to suit drill hole diameters listed above

