

Certifix CFACS

Aerated Concrete Screw

PRODUCT DESCRIPTION

Aerated concrete screw for easy installation - even without pre-drilling.

APPLICATIONS

Fastening wall cabinets for example.



PRODUCT FEATURES

- Installation possible with and also without pre-drilling: For fast and easy installation.
- High recommended loads for various aerated concrete strengths: High service loads.
- Multiple head versions: Flexibility.

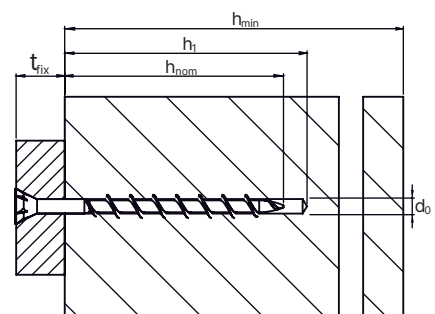

CFACS-H with hexagonal head and pressed on washer



Size	Disc-Ø
10	16,0 mm

SKU	Designation	Embedment depth of anchor h_{nom}	Max. thickness of fixture t_{fix}	Packing unit
8801	CFACS-H 10x110 SW 10	100 mm	10 mm	100
8802	CFACS-H 10x160 SW 10	100 mm	60 mm	100

CFACS-C with countersunk head and torx drive



Size	Head-Ø
8	12,0 mm
10	14,0 mm

SKU	Designation	Embedment depth of anchor h_{nom}	Max. thickness of fixture t_{fix}	Packing unit
8804	CFACS-C 8x110 SeKo VZ25	80 mm	30 mm	100
8805	CFACS-C 10x110 SeKo VZ30	100 mm	10 mm	100
8806	CFACS-C 10x160 SeKo VZ30	100 mm	60 mm	100

CFACS-P with panhead and multipoint drive



Size	Head-Ø
8	12,0 mm

SKU	Designation	Embedment depth of anchor h_{nom}	Max. thickness of fixture t_{fix}	Packing unit
8807	CFACS-P 8x80 LiKo VZ30	80 mm	-	100
8808	CFACS-P 8x100 LiKo VZ30	80 mm	20 mm	100

WITHOUT FIRE EXPOSURE, STEEL

Certifix CFACS Aerated Concrete Screw			8	10
Drill bit diameter	d_o	[mm]	0/4	0/4
Depth of drill hole	$\geq h_t$	[mm]	0/40	0/50
Embedment depth of anchor	$\geq h_{nom}$	[mm]	80	100
Recommended load for PP2 -0,50 ²⁾	$F_{empf.}$	[kN]	0,34	0,47
Recommended load for PP4 -0,65 ²⁾	$F_{empf.}$	[kN]	0,68	0,92
Recommended load for PP6 -0,80 ²⁾	$F_{empf.}$	[kN]	0,99	x
Recommended load for PP3,3 -0,60 ²⁾	$F_{empf.}$	[kN]	x	0,94
Recommended load for PP4,4 -0,70 ²⁾	$F_{empf.}$	[kN]	x	0,90
Diameter of clearing hole in the fixture	d	[mm]	9,0	10,0
Installation torque	T_{inst}	[Nm]	8	12

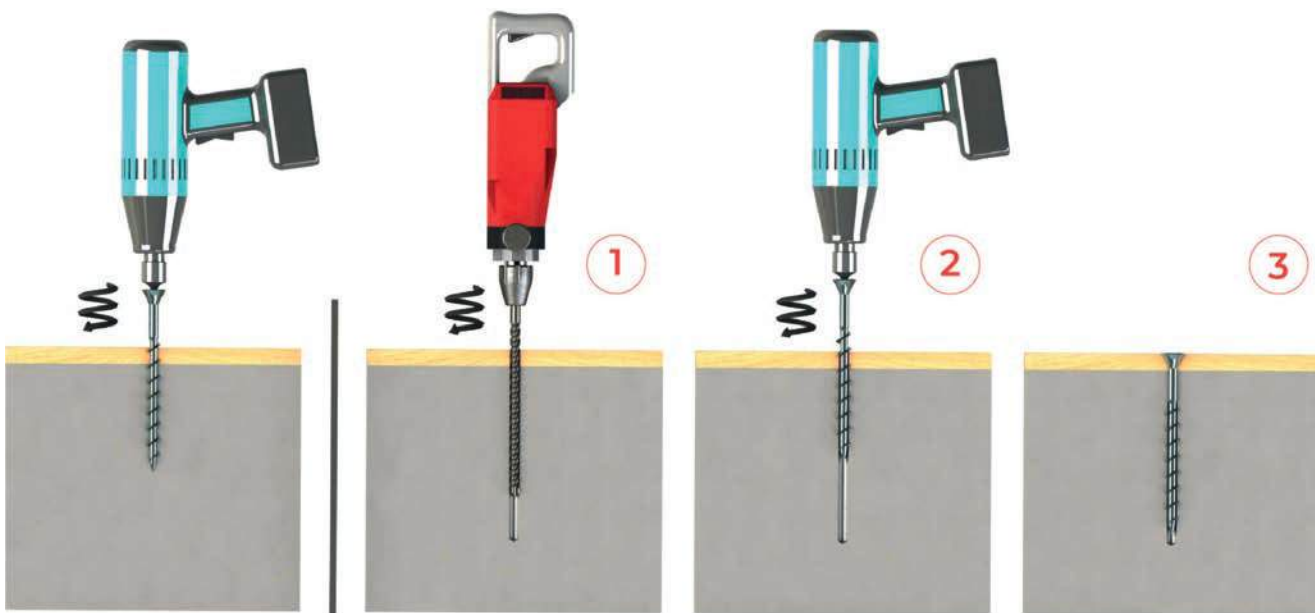

Direct installation

Installation with pre-drilling: Achieves greater load capacity

Direct Installation

Screw in without predrilling.

Installation with pre-drilling

- 1) Create drill hole
- 2) Screw in the screw.
- 3) The screw head must rest completely on the attachment part.