



Basic Threaded Probes

F73311B064G150

Order code 1004259

General

Design	Basic Contact Probe
Family	F733
Pitch [mm/mil]	4.00 / 157
Temperature [C°]	-45°C...+100°C

Electrical specifications

Continuous current [A]	10.00
Typical contact resistance [mOhm]	25.00

Mechanical specifications

Preload [cN]	50.00
Spring force [cN]	150.00
Nominal travel [mm]	4.00
Maximum travel [mm]	5.00
Pointing accuracy +/- [mm]	0.10
Thread	M2
Tool size [mm]	3.0

Dimensions

Total length [mm]	28.30
Projection height [mm]	10.30
Tip style diameter [mm]	0.64
Barrel diameter [mm]	2.65
Collar diameter [mm]	3.60
Press ring diameter [mm]	3.60
C – pin length [mm]	5.00

Materials & surfaces

Tip style	11
Plunger material	Beryllium copper
Plunger plating	Gold
Barrel material	Brass
Barrel plating	Gold
Spring material	Spring steel
Spring plating	Silver

Family drawing

All measurements are in mm.

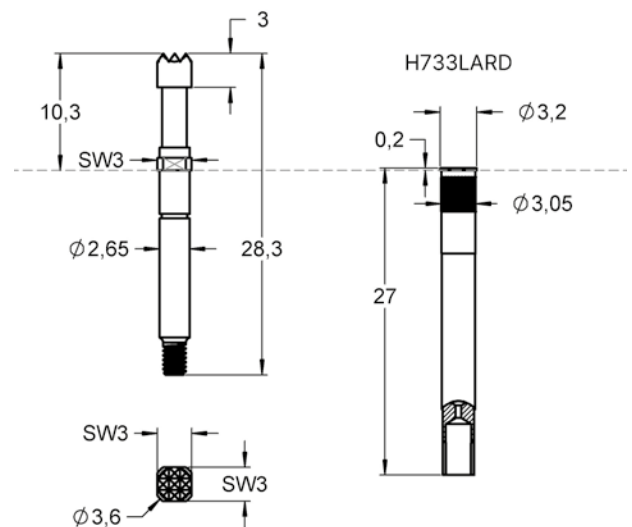

Accessories

Tool for receptacle	FEWZ-774E0
Tool for probe	1029229-FWZ733LT, 1029228-FWZ733L, 1001682-FWZ733, 1004611-FWZ733T
Other	1003077-H733LAS1, 1015833-H733LAST, 1082284-H733LARD-10, 1083352-H733LARD-10S1, 1022713-H733LARDS1

Tip style 1

