

Hotrod BW Spec Sheet



STOCK NO.	A + B SIZE	LENGTH	PCS. PER BOX
BW121	½" x 1"	5'	68
BW11	1" x 1"	5'	40

Description: Versatile and easy to use, Hotrod BW is a compressible foam solution tailor-made for fire rated bottom-wall joints. 1- and 2-hour rated (tested to UL 2079), this pre-formed firestop accessory is easily installed along the wall's bottom track, flush with the drywall. Unaffected by water, moisture or temperature, Hotrod BW is engineered to remain flexible and effective for the lifetime of the wall assembly.

- Installed on leg of bottom track after gypsum board is attached to studs.
- Remains flexible.
- Provides fire, thermal (F & T) & leakage (L) ratings.
- L-rating of below 1 CFM.
- Installs fully cured, unaffected by water/moisture/temperature.
- Red in color with vertical markings for easy identification during inspection process.
- Installs flush to face of gypsum board eliminating roll under of rubber base boards.
- Available in profiles for 1 & 2 hour wall assemblies.
- Provides Sound Transmission Classification (STC) ratings up to 56.
- Not for use in applications with permanent exposure to direct sunlight.

Storage/Warranty:

- When stored indoors and kept dry in its original package and condition, Smoke & Sound Stop has an unlimited shelf life.
- Sustainable Building Life-Cycle Warranty – see Trim-Tex Firestop Product Warranty for details.

Advantages: Maintains flexibility for the life of the interior building joint and will not shrink or pull away or harden over time. The material is odorless, will not stain, and the open cell composition prevents out-gassing.

ASTM & Code Standards:

- ASTM E84
- ASTM E90
- ASTM G21
- L-rating per UL 2079 5th Edition
- L-Rating (air leakage) testing for compliance with International Building Code (IBC) and Canadian Building Code (CBC)
- U.S. Patent No. 12,428,836

Installation Guide

Before Installation:

Clean floor surface prior to installation.

Step 1:

Place Hotrod BW on the floor against the framing.

Step 2:

Place drywall on top of Hotrod BW, ensuring that it is compressed. Leave a ½" to ¾" gap between the drywall and the floor.

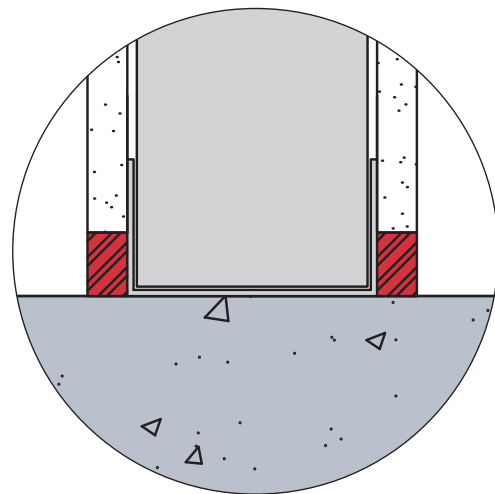

Scan Below for
Installation Video

