

O93V Expansion

Control joints have met their match! This bead is meticulously crafted of both rigid and flexible PVC to create a deep "V" that flexes to accommodate $\frac{3}{8}$ " in building movement. Tear off strips make finishing easy. Delivers high-performance ratings for smoke and sound.

Installation Guide

Technical Specs

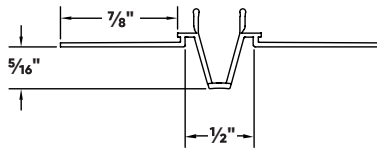

Scan Below for Installation Video



Before Installation:

Snap chalk lines as a guide. Measure, cut and dry fit the bead.

Step 1:

Coat both the bead and drywall with Trim-Tex 847 Spray Adhesive.

Step 2:

Press the bead in place, applying pressure to the mud legs.

Step 3:

Staple every 6"-8" using $\frac{1}{2}$ " staples.

Step 4:

Finish with drywall compound.

Step 5:

Remove tear-off strips prior to sanding.

Step 1:



Step 2:

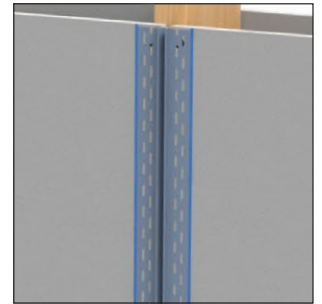

Step 3:

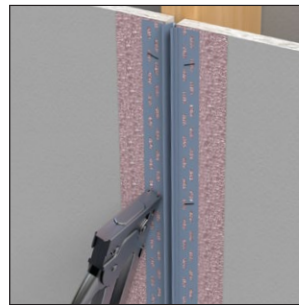

Step 4:

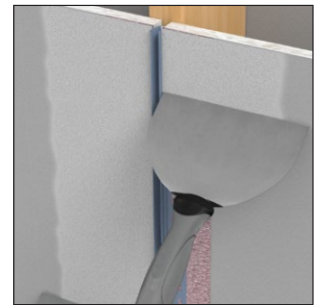

Step 5:

