

## Snipped Inside/Outside Corners:

### Step 1:

Snip the small return leg at top/back just under the bubble gasket. Do not snip through the bubble gasket.

### Step 2:

Snip 1/8" on the bottom of the Fire Gasket.

### Step 3:

Lightly score the intumescent and foam tapes with utility knife to keep it from ripping when bent. Do not cut all the way through the tapes.

### Step 4:

Bend Fire Gasket to meet the inside or outside corner and fasten into place with the foam tape and optionally with 1/2" framing screws through the lower adhesive area of the bead.

### Step 1:

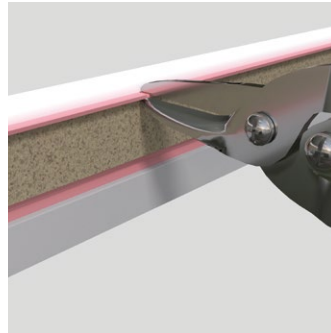

### Step 2:

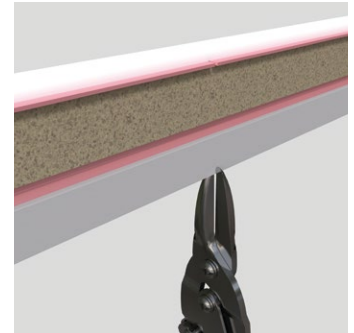

### Step 3:

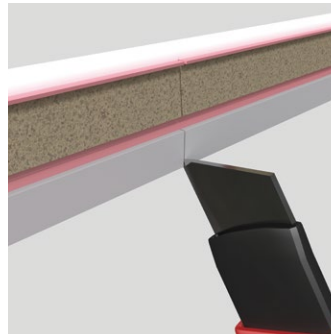

### Step 4:

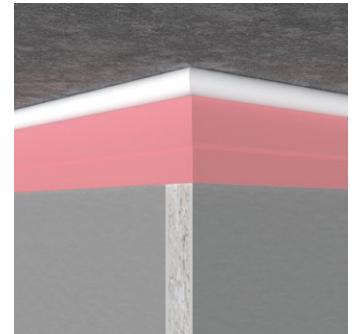

## Snipped Horizontal to Vertical Joint:

### Step 1:

Measure horizontal leg to length and snip off a flat 45° triangular section of the product.

### Step 2:

Repeat with the vertical leg, and on install, ensure there are no gaps where the intumescent tape meets.

### Step 1:

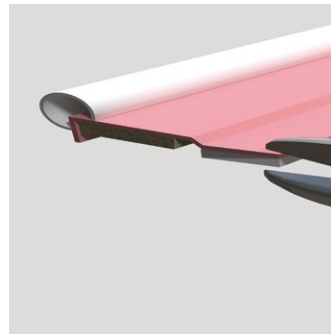

### Step 2:



## Mitered Horizontal to Vertical Joint:

### Step 1:

Measure top leg to length. Lay product flat on miter saw and make appropriate 45° cut, ensuring product is oriented properly.

### Step 2:

Repeat with vertical leg, and on install, ensure there are no gaps where the intumescent tape meets.

Step 1:

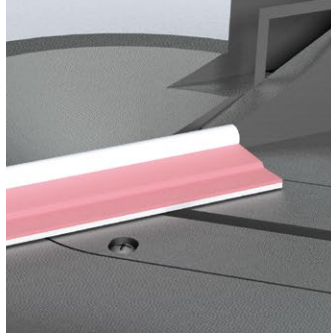

Step 2:

